

LEGEND

- 76- EXISTING CONTOUR
- 75- PROPOSED CONTOUR
- W- EXISTING WATER LINE
- ST- EXISTING STORM DRAINAGE
- SS- EXISTING SANITARY SEWER
- (136) LOT NUMBER / UNIT NUMBER
- (S) EXISTING SPECIMEN TREE & PROTECTION FENCING

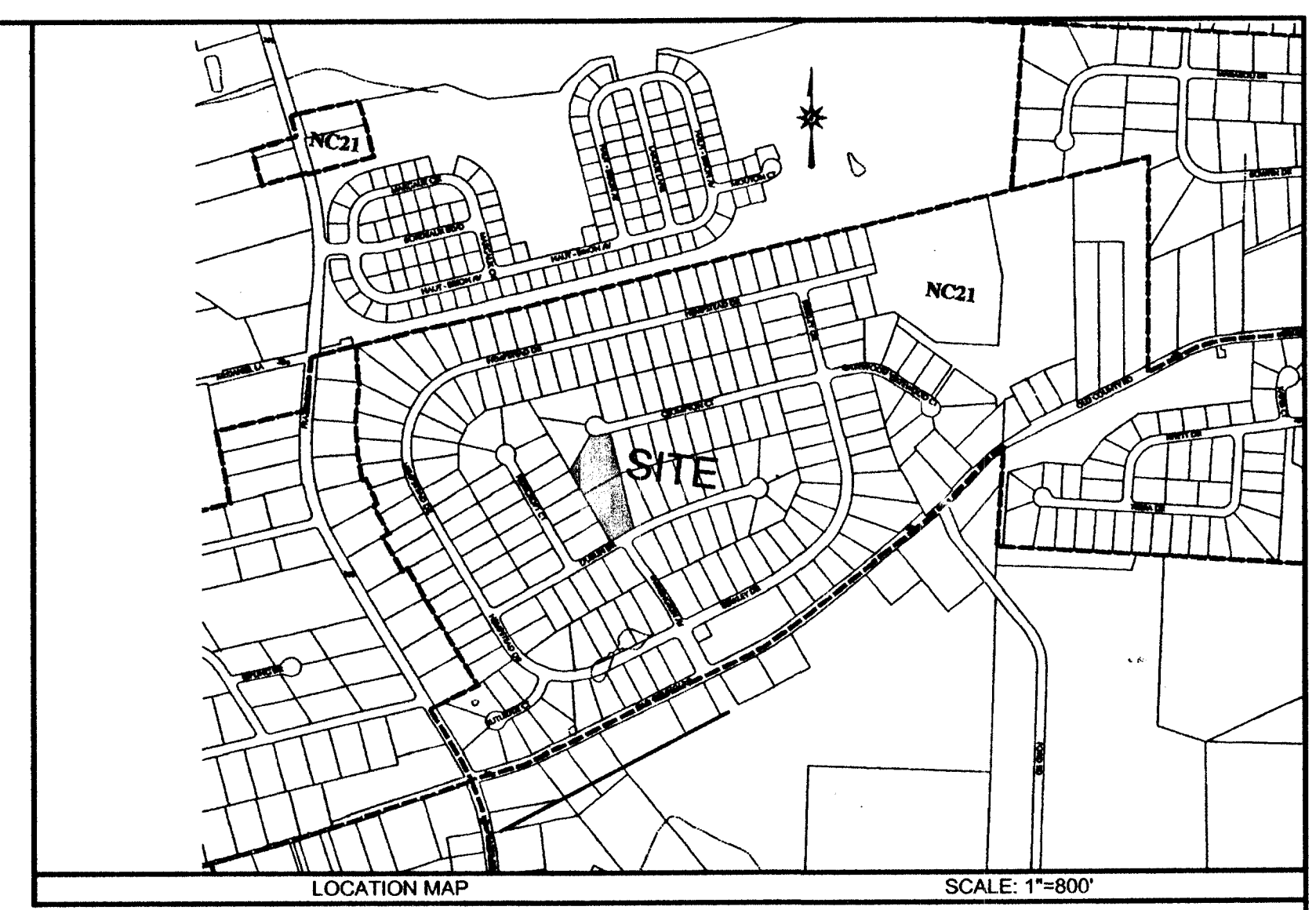

Code Requirements
 Street trees 40' o.c.
 Dublin Drive - 142' = 4 ST
 Crompton Ct. - 104' = 3 ST

Specimen Trees - to remain and be protected
 Provide 3' ht. orange snow fencing 3' beyond the drip line no grading or disturbance with the protected area.
 A - 36" Pear Tree (Pyrus)
 B - 38" Ash tree (Fraxinus)
 C - 26" Maple tree (Acer)
 Total required plant units: 0

Required:	T	O	E	S	ST
Provided:	0	0	0	0	7

Key: T = Tree, O = Understory tree, E = Evergreen tree, S = Shrub, ST = Street tree, PU = Plant Unit, O P = capacity,
 Standard type = 1-T, 2-O, 13-S Type A = 1-T, 1-E, 1-O, 11-S
 Type B = 2-O, 3-E, 7-S Type C = 4-E, 15-S Type D = 2-T/3-S

PLANTING SCHEDULE

TYPE	KEY #	BOTANICAL - COMMON NAME	MINIMUM SIZE & REMARKS
Canopy - Shade and Street Trees			
7	XST	Select from the following list provide like species on each individual street, with different species for each street front.	
ST	AR	Acer rubrum 'October Glory' - October Glory Red Maple	2.5'-3' cal. BB
ST	AS	Acer saccharum 'Green Mountain' - Sugar Maple	2.5'-3' cal. BB
ST	CL	Cladrastis kentuckea 'Perkin's Pink' - Perkin's Yellowwood	2.5'-3' cal. BB
ST	FA	Fraxinus Americana 'Autumn Purple' - Autumn Purple Am. Ash	2.5'-3' cal. BB
ST	PLA	Platanus x acerifolia 'Bloodgood' - Bloodgood London Plane Tr.	2.5'-3' cal. BB
ST	QP	Quercus palustris - Pin Oak	2.5'-3' cal. BB
ST	QS	Quercus phellos - Willow Oak	2.5'-3' cal. BB
ST	QS	Quercus shumardii - Shumard Oak	2.5'-3' cal. BB
ST	ZS	Zelkova serrata 'Green Vase' - Green Vase Zelkova	2.5'-3' cal. BB

Type Key: T = Tree, O = Understory tree, E = Evergreen, S = Shrub, G = Grasses
 GC = Ground Cover, P = Parasol, B = Balls, V = Vines
 **NOTE: All plant materials must be installed equal to or greater than the minimum sizes specified. All plants will be inspected and measured for New Castle County compliance. Prior to issuance of a Certificate of Occupancy Permit.

LOCATE OVERHEAD AND UNDERGROUND UTILITIES PRIOR TO PLANTING. FIELD ADJUST PLANT LOCATIONS AS NEEDED TO AVOID CONFLICT WITH SWALES, PIPES, DRAINAGE STRUCTURES, WIRES, UTILITY BOXES, TRANSFORMERS, EXISTING VEGETATION TO REMAIN, ETC. STOP PLANTING AND CONTACT THE LANDSCAPE ARCHITECT AND OWNER IF SOIL CONDITIONS UNSUITABLE FOR PROPER PLANT GROWTH ARE ENCOUNTERED.

- PLANTING NOTES:**
- Plant in accordance with the standards as set forth by the American Association of Nurserymen, and the American Standard for Nursery Stock.
 - Warranty all plants for two years from acceptance. Replace as originally specified, during the appropriate growing season.
 - Locate all utilities prior to digging, protect from damage during construction.
 - Field locate plants to avoid conflict with swales, utilities (above and below ground), existing vegetation to remain, transformer boxes, etc.
 - Backfill mix: One part peat humus to one part topsoil, to one part existing soil. Amendments: mix into soils. 25 lbs. 5-10-5 organic fertilizer, .75 lbs bonemeal, and 1.0 lbs. rotted cow manure per cubic foot of backfill mix. set ball top even with grade.

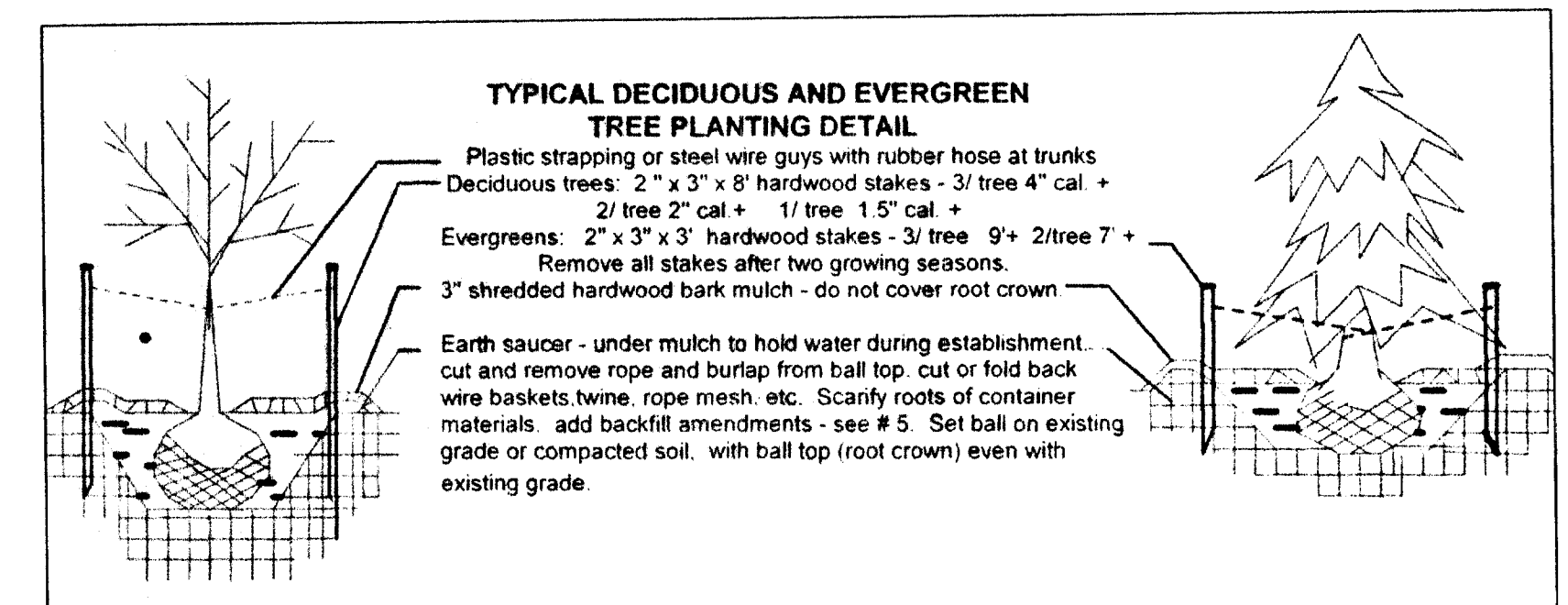

APPLICATION NO. 2007-0712
 TAX PARCEL NO. 11-036.10-037

LANDSCAPE PLAN
LOT NO. 175 & 201

FARMINGTON

SITUATE IN: PENCADER HUNDRED, NEW CASTLE COUNTY, DELAWARE

OWNER & DEVELOPER: 395 ASSOCIATES, LLC 4737 CONCORD PIKE WILMINGTON, DE 19808	DESIGNS etc. 1901 Hickory Hill Road Chadds Ford, PA 19317 (610) 388-7758
Karins CONSULTING ENGINEERS 17 POLLY DRUMMOND CENTER NEWARK, DELAWARE 19711 PH: 302-369-2900 FAX: 302-369-2975 and Associates	APPROVED: _____ PROFESSIONAL ENGINEER
SURVEY BY: K.A.	SCALE: 1" = 30'
DESIGNED BY: DESIGN ETC.	DRAWN BY: G.C.
CHECKED BY: B.M.B.	DATE: 1/25/08 SHEET 1 OF 1
	DRAWING NO. 868-L175-H01



I, UNDERSIGNED WILL BE RESPONSIBLE FOR THE IMPLEMENTATION OF THIS LANDSCAPE PLAN.

Michael E. Acinno *steph*
 OWNER DATE